



REMOTE  
CONTROL  
PROGRAMMER

User's manual

**ITALFILE®**

# INSTRUCTIONS IN OTHER LANGUAGES



- IT Istruzioni
- EN Instructions
- ES Instrucciones
- FR Instructions
- DE Anweisungen

# INDEX

## **GENERAL CONDITIONS AND WARRANTY** 4

---

## **TECHNICAL FEATURES** 5

---

Package content 5

---

Device legend 5

---

Technical data 6

---

Battery 6

---

App Italfile EasyCHECK 7

---

App connection to the device EasyCHECK 7

---

## **FUNCTIONS** 8

---

App Legend 8

---

APP updates 8

---

Remote Control Version NOW 9

---

Positioning of remote controls – Frequency 9

---

## **SOURCE CODE TRANSMISSION** 10

---

Buttons Identification, Generation,  
RC Copy, Copy Verification 10

---

Remote controls FAAC® and GENIUS® 10-11

---

Remote controls BFT® 12-13

---

Remote controls PRIME TOP and PRIME NOW 14

---

Remote controls IRIS TOP and IRIS NOW 15

---

## **RC COPY** 16

---

## **FREQUENCY AND TUNING** 17

---

## **IDENTIFICATION RESULT** 18

---

## **DISPOSAL AND DECLARATION OF CONFORMITY** 19

---

# GENERAL CONDITIONS

Dear customer, thank you for buying EasyCHECK.

We kindly ask you to read carefully and keep this instruction manual as it provides important information regarding the operation and safety of the device.

The descriptions and diagrams in this booklet are not difficult. Italfire Srl, while maintaining the main characteristics of the equipment unchanged, reserves the right to update this booklet at any time and without obligation for technical improvements or for any other commercial reason.

- The equipment must be used exclusively for the use for which it was designed. Any other use is to be considered improper and therefore dangerous.
- Use EasyCHECK away from electromagnetic disturbances.
- Do not leave EasyCHECK near heat sources or immerse it in liquids of any kind. The container is made of thermoplastic material with IP20 protection rating; therefore, it is protected from solid bodies (> 12 mm in diameter) but not from liquids such as drops, vapors or splashes in any direction.
- Do not ingest the batteries, risk of chemical burns.

**ATTENTION!** If the notes described above are not respected, the manufacturer cannot be held responsible for damage to people, things and animals resulting from the improper use of EasyCHECK.

## WARRANTY

The EasyCHECK warranty is 24 months from the fiscally documented purchase date. This warranty covers the failure to function of EasyCHECK for all defects resulting from manufacturing, excluding those caused by negligence, improper use, tampering and atmospheric agents.

Products that have been tampered with will not be repaired. The company Italfire Srl does not assume any responsibility for damage to things or people caused by improper use, poor application of the rules of use or illegal uses. Likewise, it is not liable for damages caused by the failure or inefficiency of the appliance.

Do not remove the cover. This product contains no user-replaceable parts. Maintenance requires the intervention of qualified personnel.

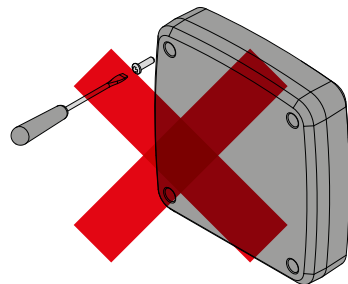

# TECHNICAL FEATURES

## Package content

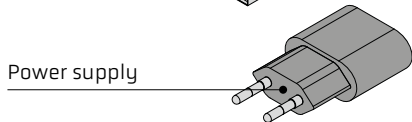
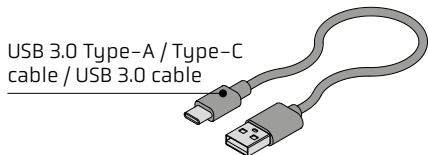
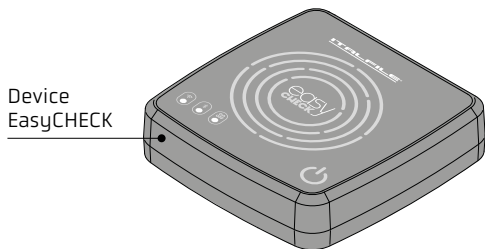

## Device legend

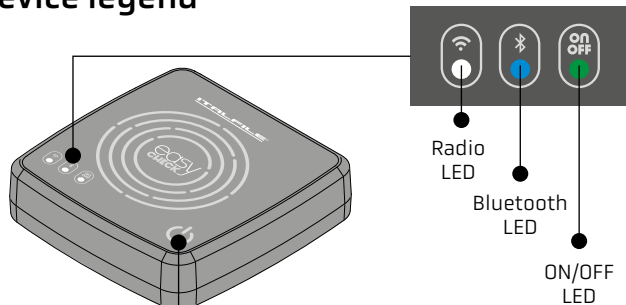

ON/OFF button

USB Type-C port

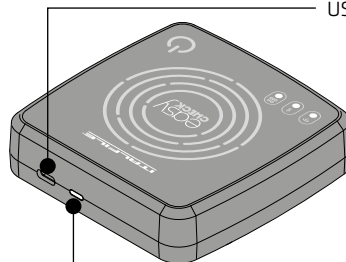

# TECHNICAL FEATURES

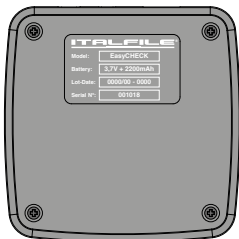

## Technical data

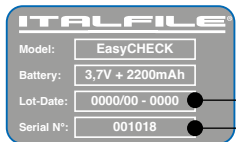

Lot and year of manufacture

Serial number of the device

Battery	3,7 V with rechargeable lithium batteries – 220 mAh (included)
Input	5.0V --- 2.0A
Frequency	[20-40 / 433-868] MHz
Dimensions	[102 x 102 x 26] mm
Weight	200 g (battery included)
Degree of protection	IP20
Operating temperatures	5°C / +40°C



## Battery



Battery life is approximately 8 hours. When the ON/OFF LED starts flashing, it means that the battery has 25% remaining autonomy. To charge EasyCHECK, insert the USB Type-C cable into the relevant port on the back of the instrument. The LED on the back will light up red. Once charging is complete (approximately 2 hours) the LED will turn green. We recommend the use with the supplied power supply.

Note: The battery status is also visible in the app by clicking  
> ADVANCED OPTIONS  
> BATTERY STATUS

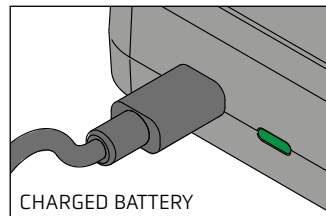
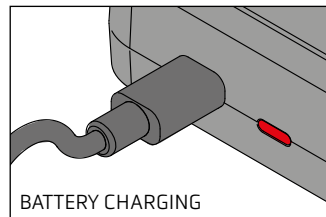
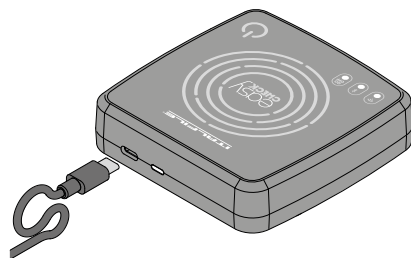

# TECHNICAL FEATURES

## App Italife EasyCHECK



Search the application "Italife Easy Check" in the App Store or Play Store and download it to your smartphone.

Agree to use EasyCHECK on Bluetooth.

Now the application will be available on your smartphone.



## App connection to the device EasyCHECK



To use EasyCHECK, your smartphone must necessarily be connected to a mobile network.

- > Press the ON/OFF button on EasyCHECK for about 5 seconds to turn it on (the ON/OFF LED will turn green).
- > Activate Bluetooth on your smartphone.
- > Press the "START" button.
- > The "HOME" screen will open, the Bluetooth LED will turn blue.



To turn off EasyCHECK, keep pressed the ON/OFF button for a long time until the relevant LED turns off.



# FUNCTIONS

## APP legend

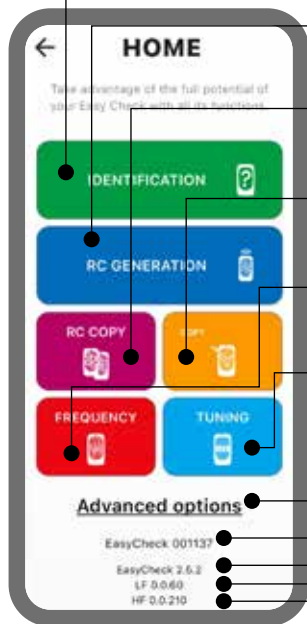

### IDENTIFICATION button

It allows you to identify the characteristics of the original remote controls and how they are activated in the control unit.

### RC GENERATION button (only for version NOW)

It allows you to create a remote control using the list on EasyCHECK.

### RC COPY button (only for version NOW)

This feature allows you to copy by following the instructions displayed by EasyCHECK.

### COPY button

This feature allows you to check whether the copy was made correctly.

### FREQUENCY button

This function allows you to check the frequency of the remote controls.

### TUNING button

This function allows you to tune and check the power of remote controls with frequencies between 20 and 40 MHz.

### ADVANCED OPTIONS button

To see the battery status and any updates.

Serial number of the device you are using.

Device update version.

Low Frequency update version.

High Frequency update version.

## APP updates

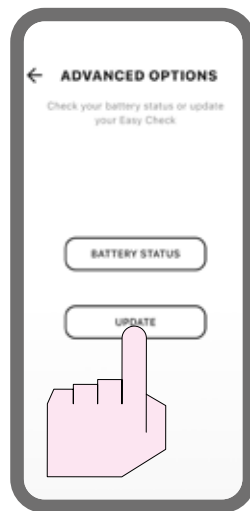

Check periodically for new versions of the device. The update must be performed with the power cable plugged in.



# FUNCTIONS

## Remote controls version NOW



These 2 functions can only be performed with remote controls version NOW. The version is specified on the back of the remote control.



## Positioning of remote controls - Frequency

FIG. 1

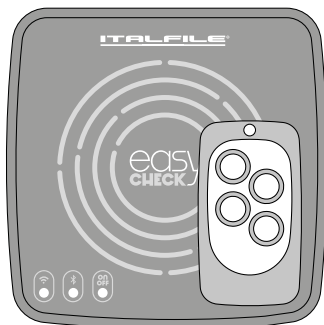

The remote controls, in all their functions, must be positioned on EasyCHECK as shown in figures 1.

Remote controls with frequencies from 20 to 40 MHz must be positioned as indicated in figure 2.

FIG. 2



In every function, except the "GENERATION" one, the RADIO LED must always flash. If not, exit the app and re-enter.

# SOURCE CODE TRANSMISSION

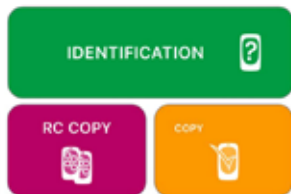

For some models of remote controls, it will be possible to execute and conclude these three functions only after EasyCHECK has requested the transmission of the source code. However, EasyCHECK will not be able to provide instructions on how to send it, as it does not yet know the specific model. Since each model has a unique transmission method, you will need to know this before performing identification.

## Remote controls FAAC® and GENIUS®

### FAAC®



### ATTENTION:

all these remote control models have the key sequence as shown in the drawing below.

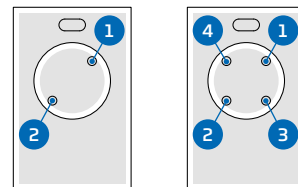

### GENIUS®

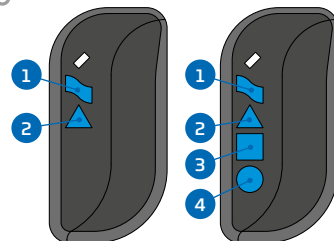

All brands or trade names of products mentioned are the property of the manufacturers. These brands are indicated for information and educational purposes only, with the aim of facilitating identification.

# SOURCE CODE TRANSMISSION

## Remote controls FAAC® and GENIUS®

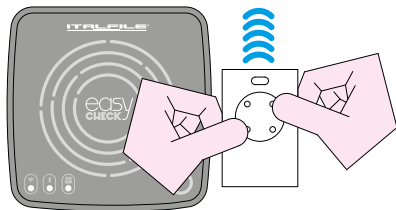
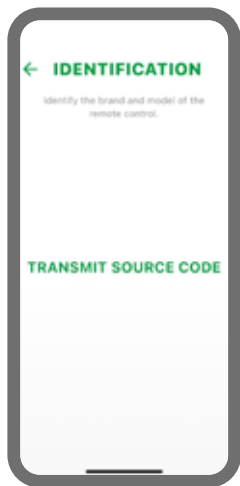

1. Move the remote control away from EasyCHECK and press buttons 1 and 2 simultaneously until the remote control LED flashes.

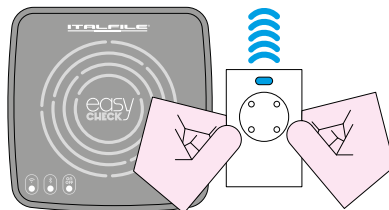

2. Release the buttons (the LED continues to flash).

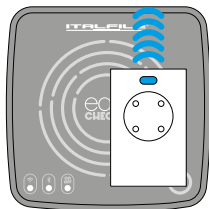

3. Place the remote control on top of EasyCHECK.



4. Press the working button.



The RADIO LED must always flash. If not, exit the app and re-enter.

# SOURCE CODE TRANSMISSION

## Remote controls BFT®



TRC



MITTO A



MITTO



RB



GHIBLI



B RCB



KLEYO

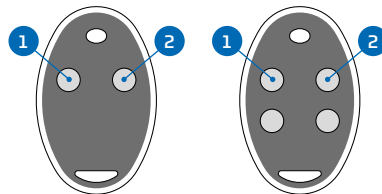

To transmit the source code, press buttons 1 and 2 of all BFT remote controls simultaneously.

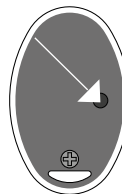

In the MITTO versions, if there is a button on the back of the remote control, press this button only.

All brands or trade names of products mentioned are the property of the manufacturers.  
These brands are indicated for information and educational purposes only, with the aim of facilitating identification.

# SOURCE CODE TRANSMISSION

## Remote controls BFT®

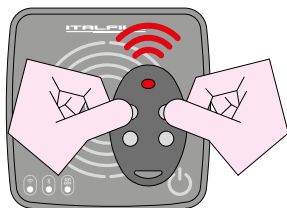
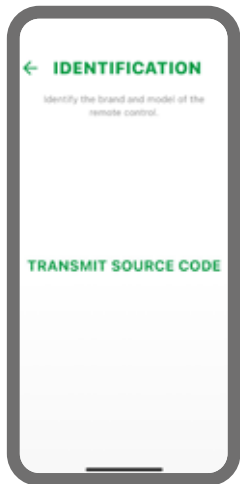

1. Press buttons 1 and 2 simultaneously.

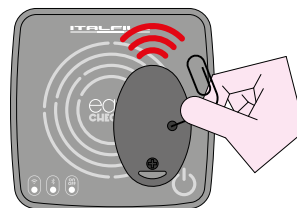

2. If there is a button on the back, press it with a pin/clip.



The RADIO LED must always flash. If not, exit the app and re-enter.

# SOURCE CODE TRANSMISSION

## Remote controls PRIME TOP and PRIME NOW

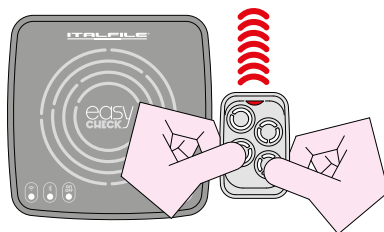
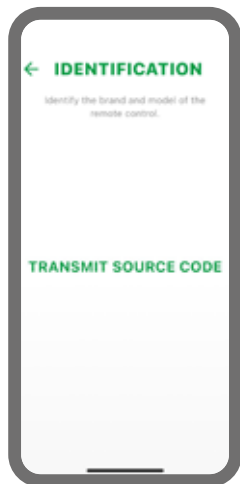

1. Move the remote control away from EasyCHECK and press buttons 1 and 2 simultaneously until the remote control LED flashes.

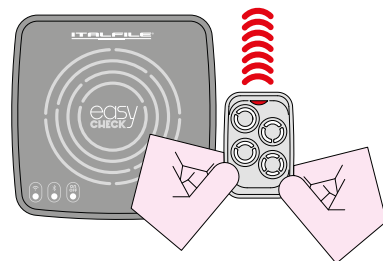

2. Release the buttons (the remote control LED continues to flash).



3. Place the remote control on top of EasyCHECK (the LED continues to flash).



4. Press the working button.



The RADIO LED must always flash. If not, exit the app and re-enter.

# SOURCE CODE TRANSMISSION

## Remote controls IRIS TOP and IRIS NOW

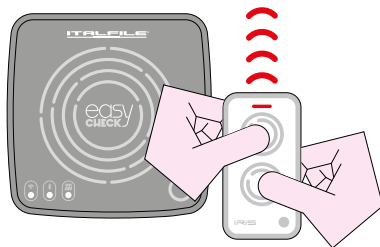
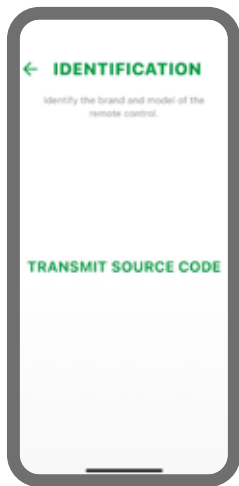

1. Move the remote control away from EasyCHECK and press buttons 1 and 2 simultaneously as shown until the remote control LED flashes.

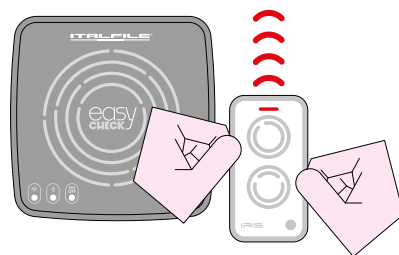

2. Release the buttons [the LED continues to flash].

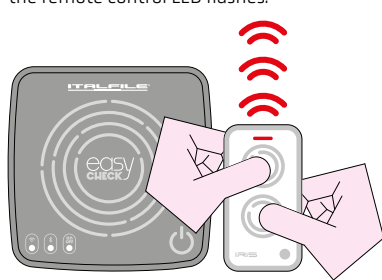

3. Press again the 2 buttons for a couple of seconds until the LED flashes twice followed by a pause.

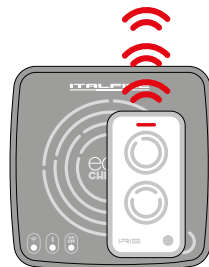

4. Place the remote control on top of EasyCHECK [the LED continues to flash in the same way].



5. Press the working button.



The RADIO LED must always flash. If not, exit the app and re-enter.

# RC COPY

## RC COPY



This function allows you to copy remote controls “step by step” without knowing the duplication procedures. Furthermore, it allows you to duplicate remote controls that cannot be duplicated with each other, such as 128 bit and Faac Slave remote controls.

### 4 BUTTON VERSION

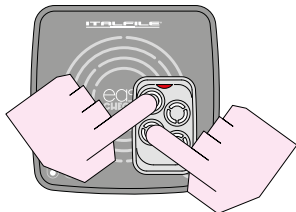

1. Press the buttons simultaneously until the remote control LED flashes green.



2. Once released the buttons, wait for the remote control to stop flashing and for the EasyCHECK app to complete the procedure.

### 2 BUTTON VERSION

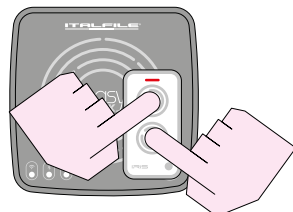
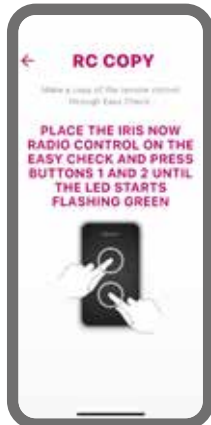

1. Press the buttons simultaneously until the remote control LED flashes green.



2. Once released the buttons, wait for the remote control to stop flashing and for the EasyCHECK app to complete the procedure.



The RADIO LED must always flash. If not, exit the app and re-enter.



# FREQUENCY AND TUNING

## FREQUENCY



This function allows you to check the frequency of remote controls.

To correctly detect the frequency, place the remote control over EasyCHECK in the positions:

- shown in figure 1 on page 9 for remote controls with frequency 433-868 MHz;
- shown in figure 2 on page 9 for remote controls with frequency 20-40 MHz.



The RADIO LED must always flash. If not, exit the app and re-enter.

## TUNING

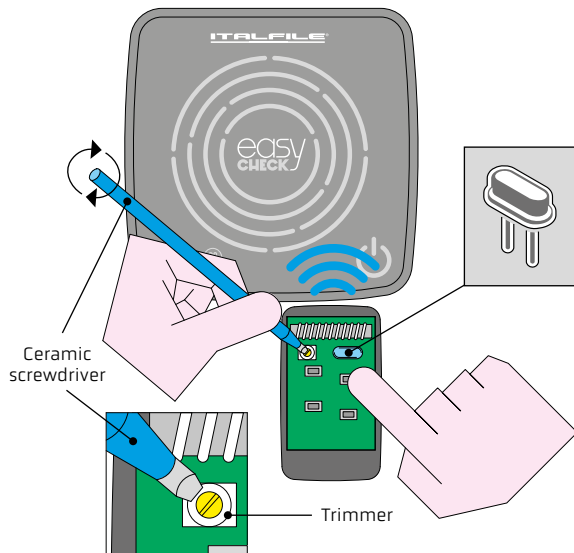
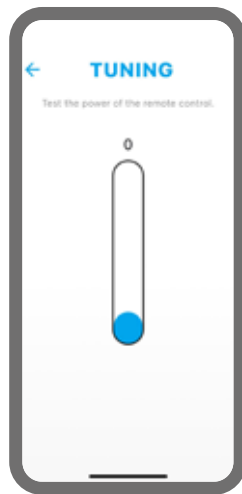

This function allows you to check the power of remote controls with a frequency between 20 and 40 MHz. Furthermore, it is possible to tune the quartz by acting on the trimmer using a ceramic screwdriver to bring the value to 100 [see figure].

# IDENTIFICATION RESULT

Once the remote control to be duplicated has been identified, EasyCHECK provides 3 kinds of information:

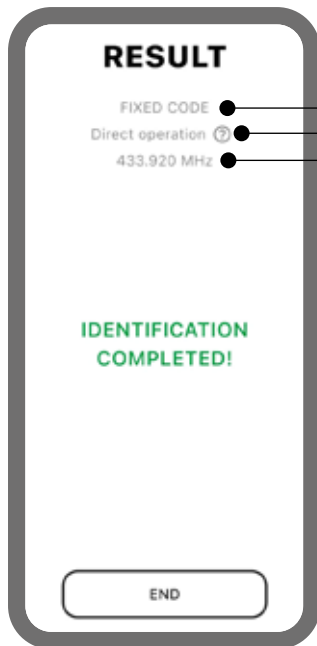

Original remote control brand

Type of storage (to be carried out in the immediate vicinity of the system):

- manual memorisation
- automatic memorisation
- direct operation

Frequency

### **Manual memorisation:**

once duplicated the remote control, press the radio button inside the system to activate it

### **Automatic memorisation:**

once duplicated the remote control, for activation press the programmed button, when the RED LED starts to flash GREEN, release the button. Wait for the LED to stop flashing, then press the button again to check correct operation.

### **Direct operation:**

once duplicated the remote control button, to activate it press the copied button one or more times (depending on the model).

# DISPOSAL AND DECLARATION OF CONFORMITY

## Disposal



The disposal of materials must be done in compliance with current regulations and it is advisable to separate them by type (cardboard, plastic, electrical parts).

## Declaration of conformity

ITALFILE SRL hereby declares that the programmer EasyCHECK complies with the essential requirements established by Directive 2014/53/EU.

**ITALFILE®**

**ITALFILE® Srl** • Via Gualda, 11 • 36075 Montecchio Maggiore (VI) Italy  
Tel. +39 0444 371303 • [info@italfile.it](mailto:info@italfile.it) • [www.italfile.it](http://www.italfile.it)