



# PRIME

**TOP VERSION**

**100% MADE IN ITALY**

**ITALFILE®**

ITALFILE® Srl • Via Gualda, 11 • 36075 Montecchio Maggiore (VI) Italy  
Tel. +39 0444 371303 • info@italfile.it • www.italfile.it

# PRIME

## TOP VERSION

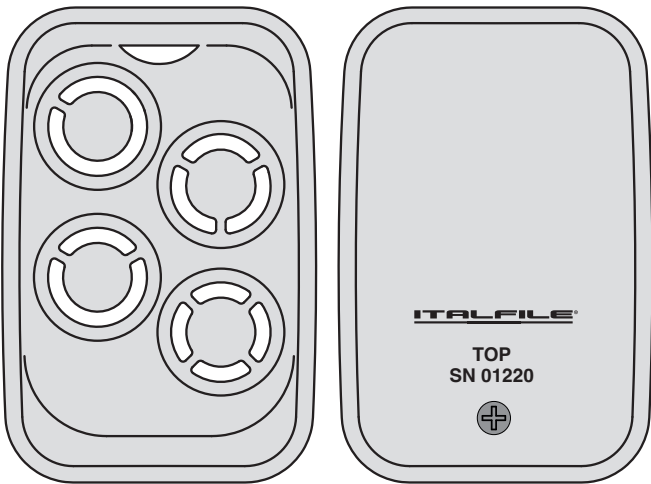

Compatible with most fixed-code and rolling-code remote controls with different frequencies for each individual button, excluding frequencies from 20 to 40 MHz



Dual Led  
Green = fixed code  
Red = Italfile rolling code



Battery CR2032



Shockproof coating

### DISPOSAL

None of the product components have any particular risks. The various parts must be separated by type (plastic, electric parts, battery).

### DECLARATION OF CONFORMITY

The manufacturer ITALFILE S.R.L. declares that the radio equipment type Prime version TOP SN01220 – TOP SN01322 is compliant with Directive 2014/53UE (RED). The full text is available at: [www.italfile.it](http://www.italfile.it)

Montecchio Maggiore Vicenza 09/11/2022

Responsible person, Pellattiero 

### TECHNICAL CHARACTERISTICS

BAND 433 MHz	From 433.03 to 435.43 MHz
BAND 868 MHz	From 868.03 to 870.43 MHz
POWER	-6 dBm
SUPPLY	CR2032 battery
CODE	OOK/FSK
CHANNEL NUMBER	2



# INDEX

LEGEND OF LED SYMBOLS	p. 4
ROLLING CODE DUPLICATION PROCEDURE STANDARD	p. 5
FIXED CODE DUPLICATION PROCEDURE	p. 6
BFT® CODE DUPLICATION PROCEDURE	p. 7
FAAC®/GENIUS® CODE DUPLICATION PROCEDURE	p. 8
AVIDSEN®/V2® CODE DUPLICATION PROCEDURE	p. 9
BFT®/FAAC®/GENIUS® CODE DUPLICATION PROCEDURE FROM PRIME TO A NEW PRIME	p. 10
IDENTICAL COPY PROCEDURE	p. 11
ALL BUTTONS PROCEDURE	p. 12
CONTINUOUS TRANSMISSION PROCEDURE	p. 13
MANUAL RECEIVER STORAGE	p. 14
AUTOMATIC RADIO RECEIVER STORAGE	p. 15
DIRECT LEARNING	p. 16
HIDDEN BUTTON/SOURCE FUNCTION	p. 17

## LEGEND OF LED SYMBOLS



Green led



Red led



Led off



Pause



Slow flashes



Quick flashes

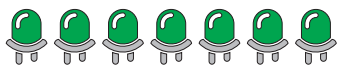

Green steady light



Red steady light

---



# ROLLING CODE DUPLICATION PROCEDURE STANDARD

1

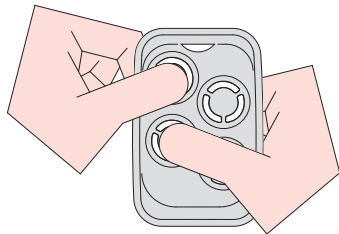
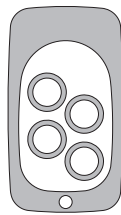

2

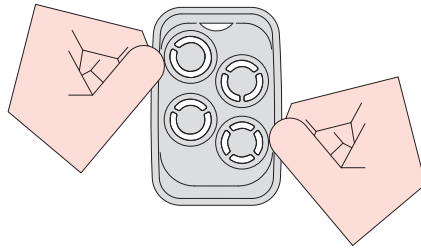
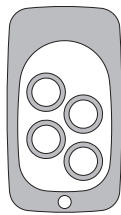

3

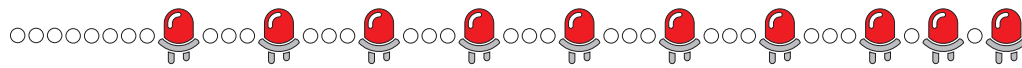
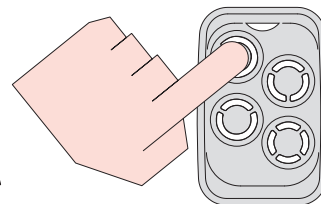
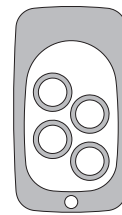

Press both Prime buttons  
simultaneously

Release when  
the Led flashes

Press the button  
you want to store

4

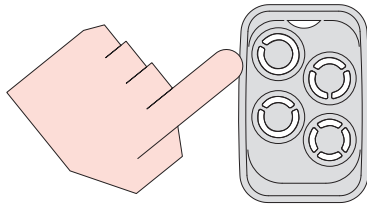
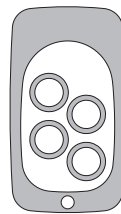

5

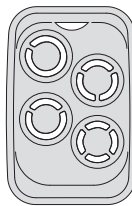
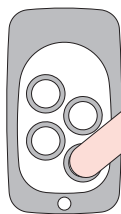

6

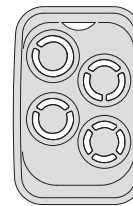
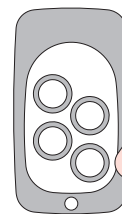

Release when the  
Led flashes rapidly

Press the button on the  
original remote control that  
you want to duplicate

When the Led becomes  
steady, release it and wait  
for it to turn off



Once the procedure is complete, the programmed button will transmit the signal with the RED LED. To make it work, depending on the model, you will need to perform either the **MANUAL STORAGE OR THE AUTOMATIC RADIO RECEIVER STORAGE.**



# FIXED CODE DUPLICATION PROCEDURE

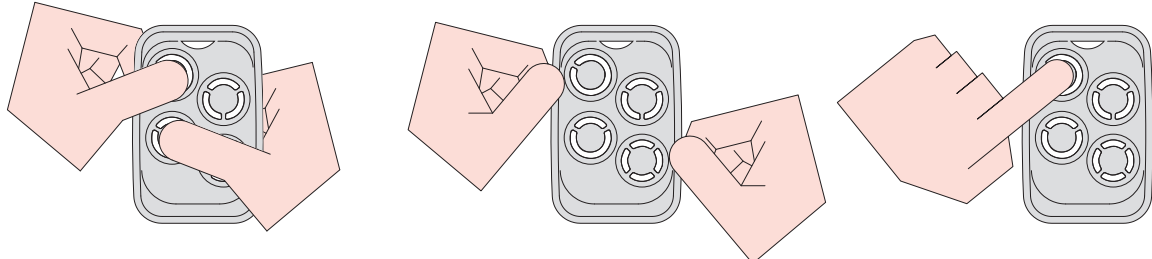
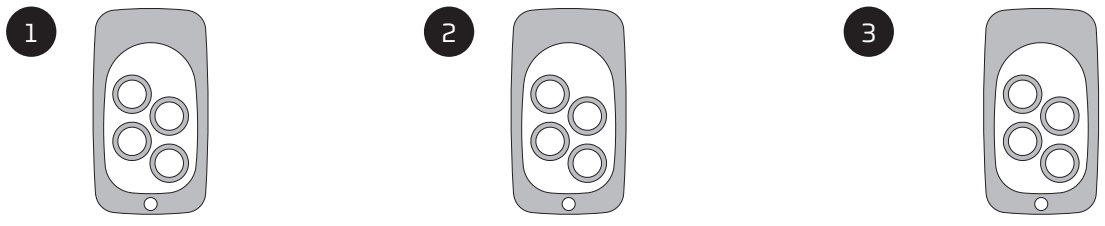

Press both Prime buttons simultaneously

Release when the Led flashes

Press the button you want to store

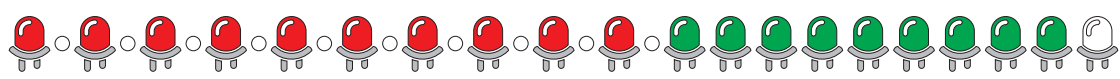
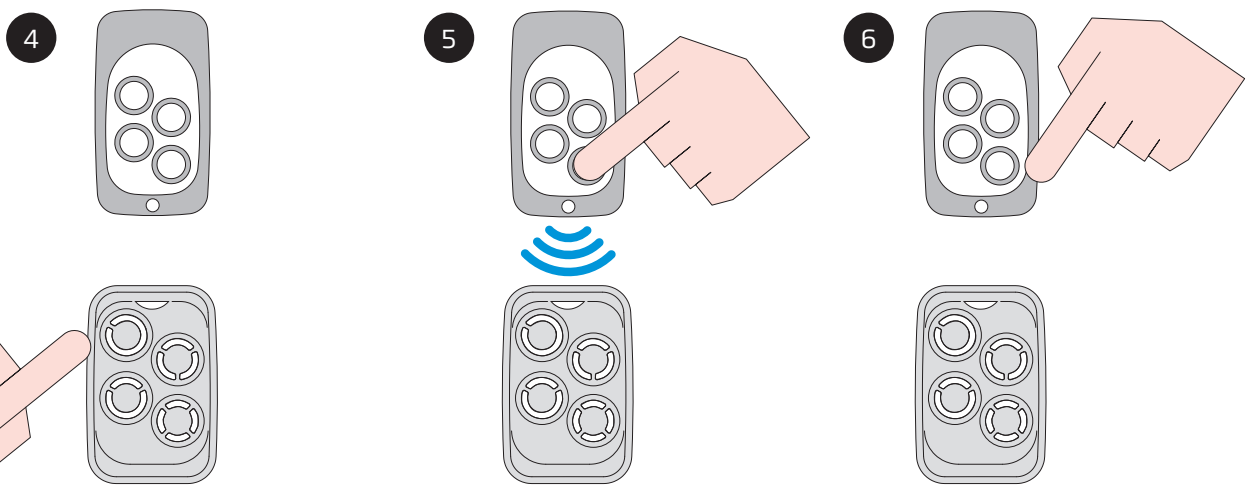

Release when the Led flashes rapidly

Press the button on the original remote control that you want to duplicate

When the Led turns solid green, release and wait for it to turn off



Once the procedure is complete, the programmed button will transmit the signal with the GREEN LED and will be immediately operational. **DIRECT LEARNING.**



# BFT<sup>®</sup> CODE DUPLICATION PROCEDURE

The procedure also includes the transmission of the source code from the original remote control. The source code is transmitted by pressing both buttons simultaneously or by pressing the button located on the back of the remote control.

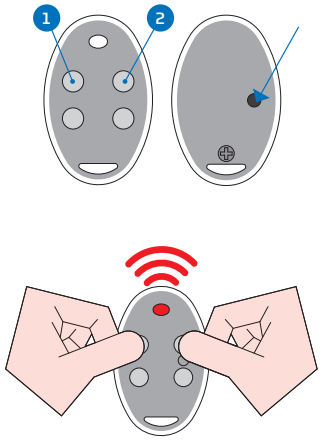

To transmit the source code, press buttons 1 and 2 simultaneously on all BFT remote controls.

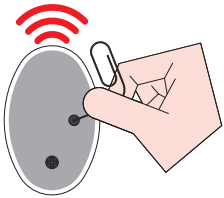

In the MITTO versions, if the button is present on the back of the remote control, press only this button.

**1** Press both Prime buttons simultaneously

**2** Release when the Led flashes

**3** Press the button you want to store

**4** Release when the Led flashes more quickly

**5** Press the button on the original remote control that you want to duplicate

**6** When the Led becomes steady, release.

**7** The Led starts flashing rapidly again

**8** Press the buttons on the original remote control to transmit the source code

**9** When the Led becomes steady, release the buttons and wait for the Led to turn off



Once the procedure is complete, the programmed button will transmit the signal with the RED LED. To make it work, you will need to perform the **AUTOMATIC RADIO RECEIVER STORAGE**.



# FAAC®/GENIUS® CODE DUPLICATION PROCEDURE

The procedure should only be performed if the original remote control is a master, that is, when pressing one of the buttons causes the Led to flash twice. If the Led remains steady, the procedure cannot be executed.

### WARNING:

All these remote control models have the button sequence as shown in the diagram below.

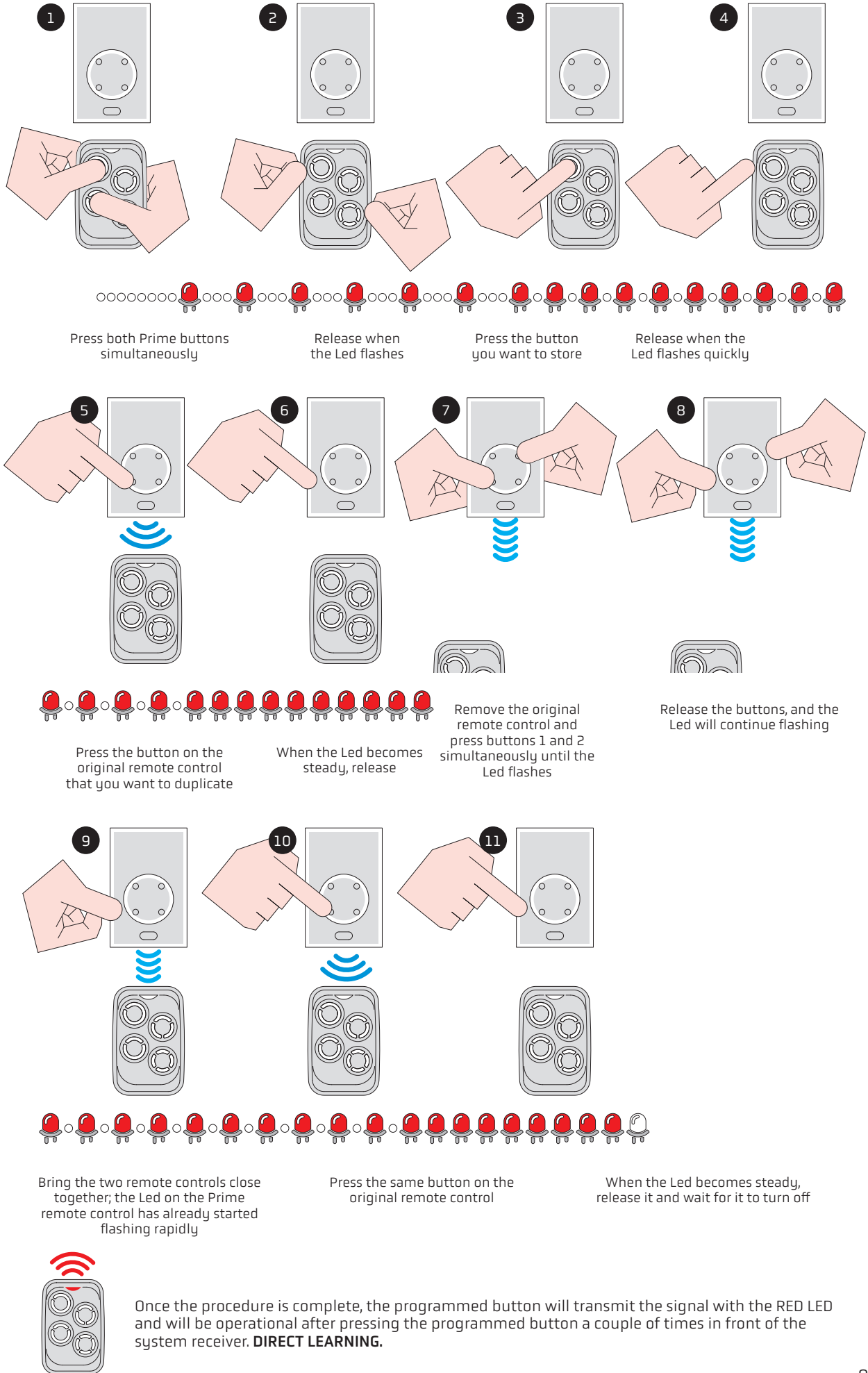
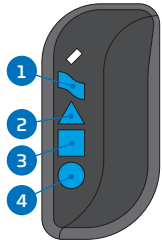
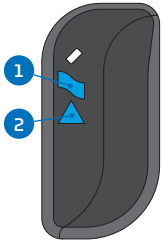
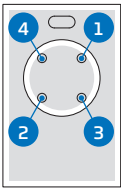
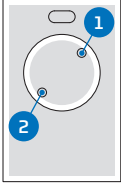





# AVIDSEN®/V2® CODE DUPLICATION PROCEDURE

1

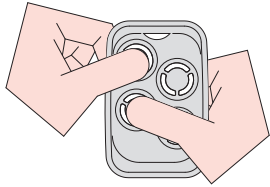
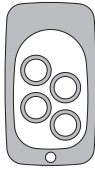

Press both Prime buttons simultaneously

2

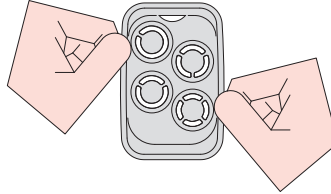
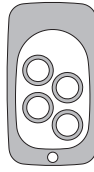

Release when the Led flashes

3

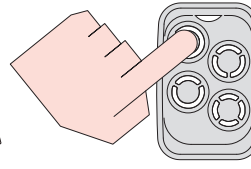
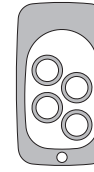

Press the button you want to store



4

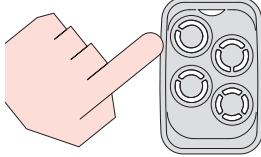
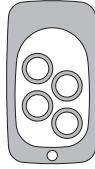

Release when the Led flashes rapidly.

5

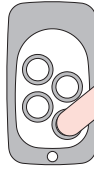

Press the button on the original remote control that you want to duplicate

6

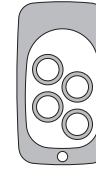

When the Led becomes steady, release



7

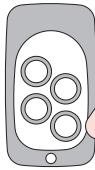

The Led will start flashing rapidly again

8

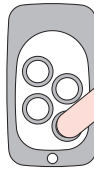

Press the same button on the original remote control again

9

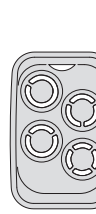
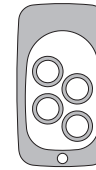

When the Led becomes steady again, release and wait for it to turn off



Once the procedure is complete, the programmed button will transmit the signal with the RED LED. To make it work, for AVIDSEN® you will need to perform **MANUAL STORAGE**, while for V2® **AUTOMATIC RADIO RECEIVER STORAGE** will be required.



# BFT®/FAAC®/GENIUS® CODE DUPLICATION PROCEDURE FROM PRIME TO A NEW PRIME

**A** Already programmed remote control

**B** New remote control to be programmed



Press both buttons simultaneously      Release when the Led flashes      Press the button you want to store      Release when the Led flashes rapidly

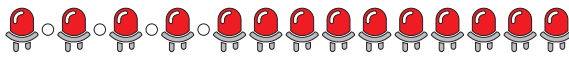
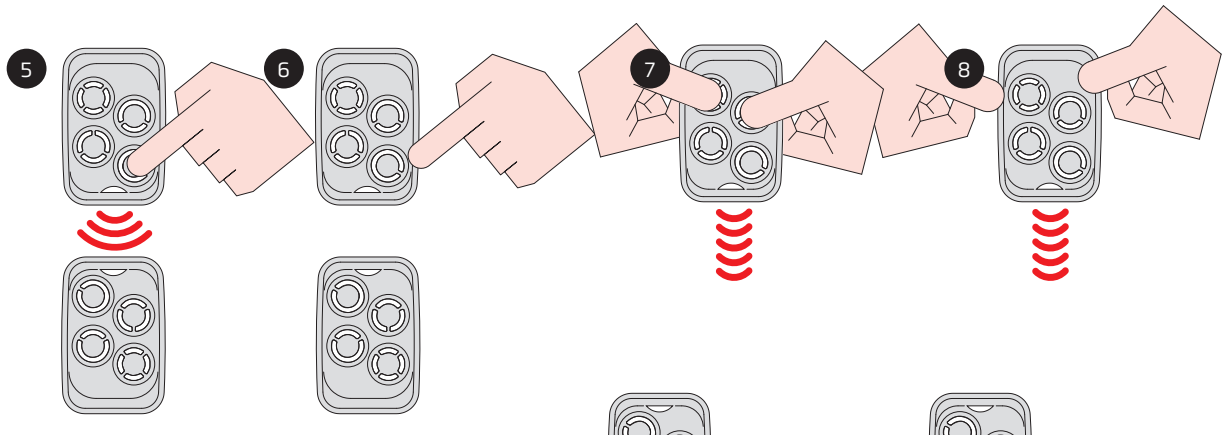

Press the button you want to duplicate      When the Led becomes steady, release      Move the remote control away and press both buttons simultaneously until the Led flashes      Release both buttons

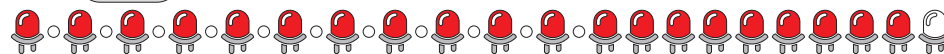
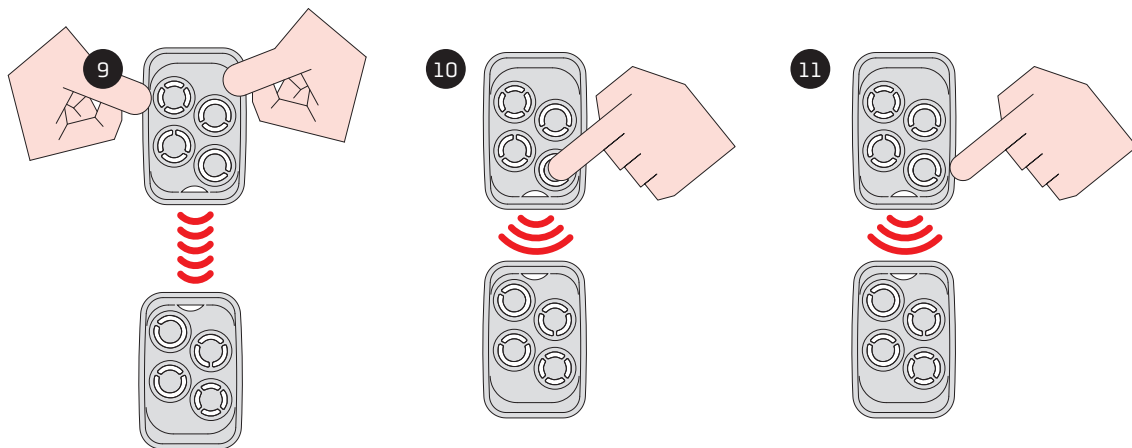

Bring the two remote controls close together; the Led on the new Prime has already started flashing rapidly again      Press the same button that you want to duplicate again      When the Led becomes steady, release it and wait for it to turn off



Once the procedure is complete, the programmed button will transmit the signal with the RED LED. To make it work, for BFT® you will need to perform **AUTOMATIC RADIO RECEIVER STORAGE**, while for FAAC®/GENIUS® it will be operational after pressing the programmed button a couple of times in front of the system receiver. **DIRECT LEARNING.**



# IDENTICAL COPY PROCEDURE

This procedure allows you to copy the button from the original remote control with the same serial number.

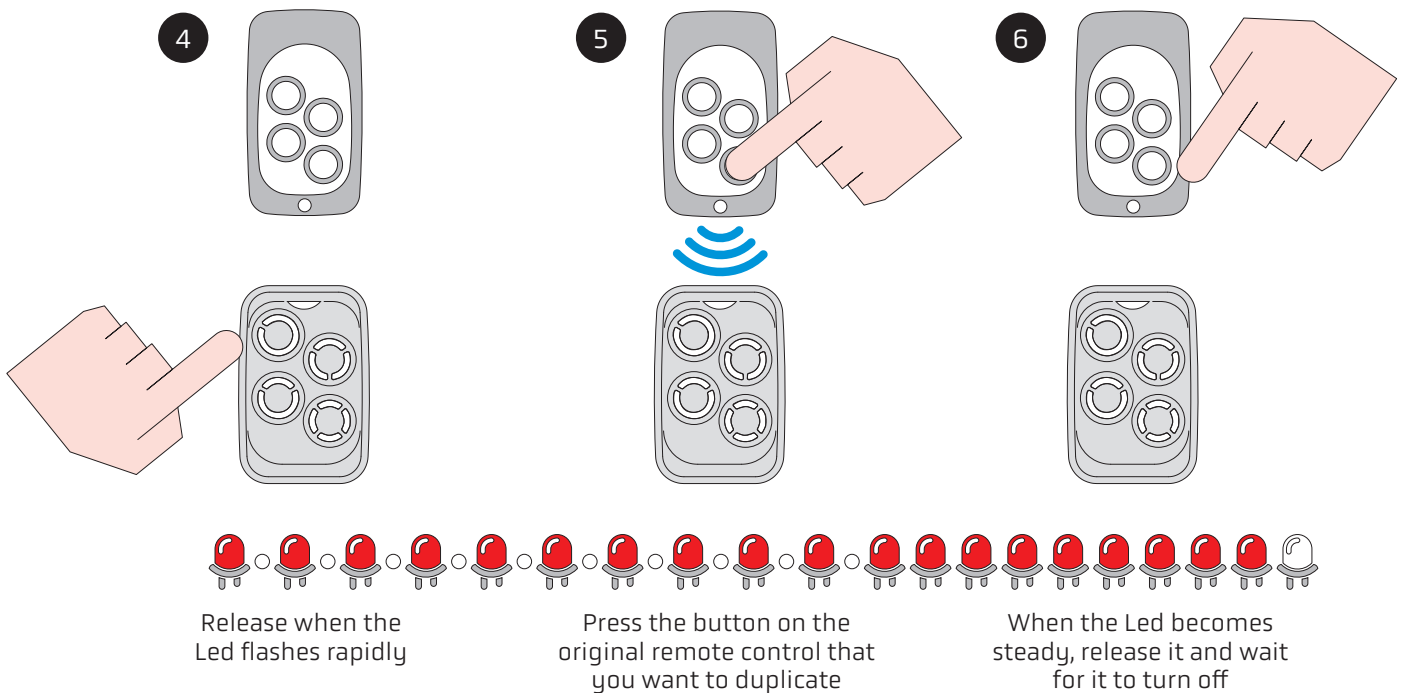
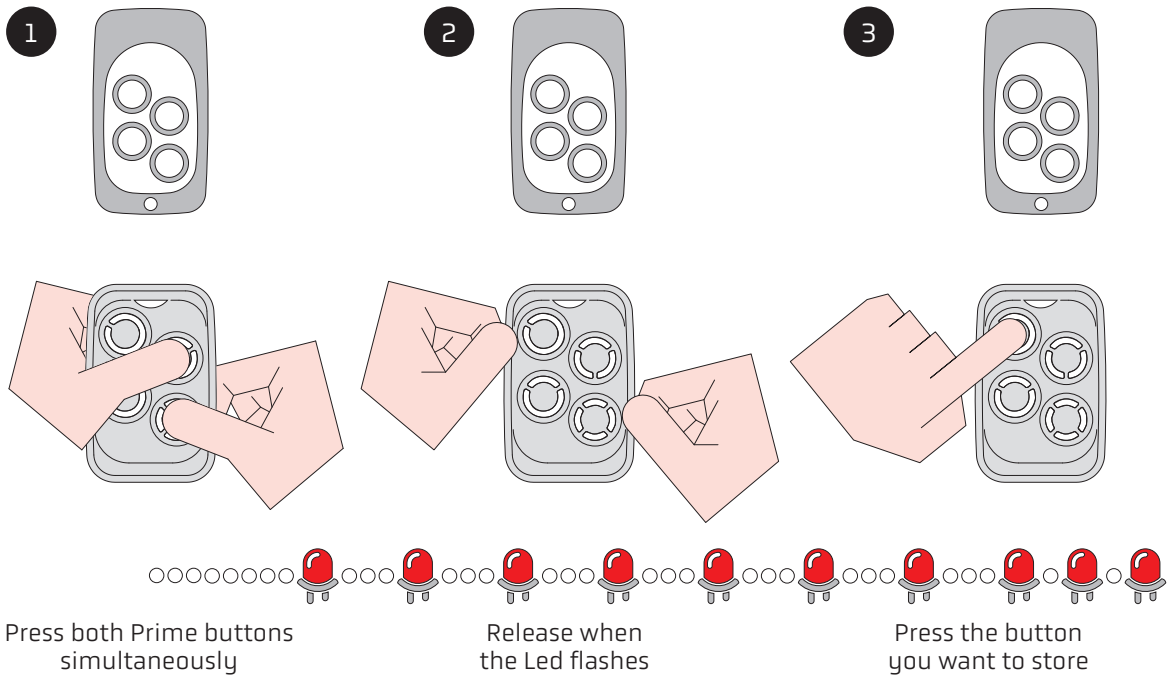

Once the procedure is complete, the programmed button will transmit the signal with the RED LED and will be immediately operational. **DIRECT LEARNING.**



# ALL BUTTONS PROCEDURE

This procedure is used when more than one button on the original remote control is programmed on a single receiver of the system (for example, the first button fully opens, while the second controls the pedestrian opening). It allows you to duplicate all the buttons of the original remote control onto both buttons of PRIME and is only applicable for NICE® models.

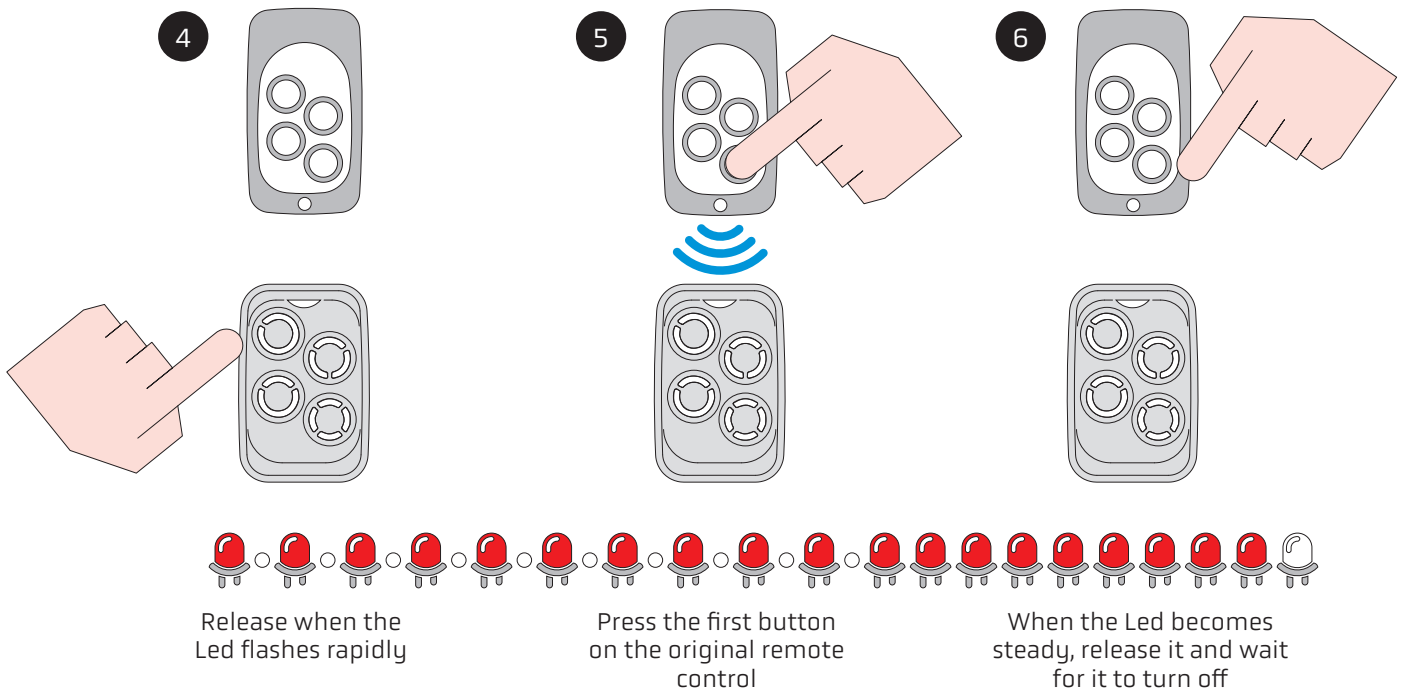
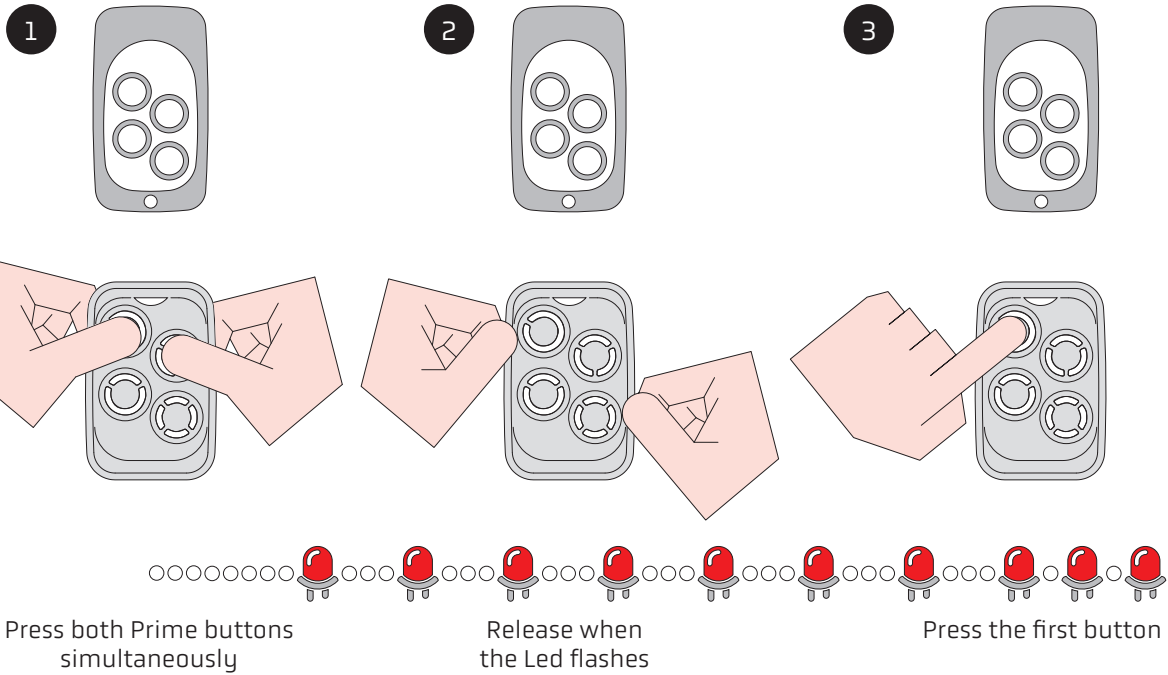

Once the procedure is complete, all the buttons will transmit the signal with the RED LED. To make them work, you will need to perform **AUTOMATIC RADIO RECEIVER STORAGE** activated by the first stored button. After completing the procedure in front of the system receiver, all the buttons will be stored on all the receiver's channels.



# CONTINUOUS TRANSMISSION PROCEDURE

This procedure is performed after the Prime remote control has already been programmed and is functioning, and allows the signal to be transmitted until the button is released.

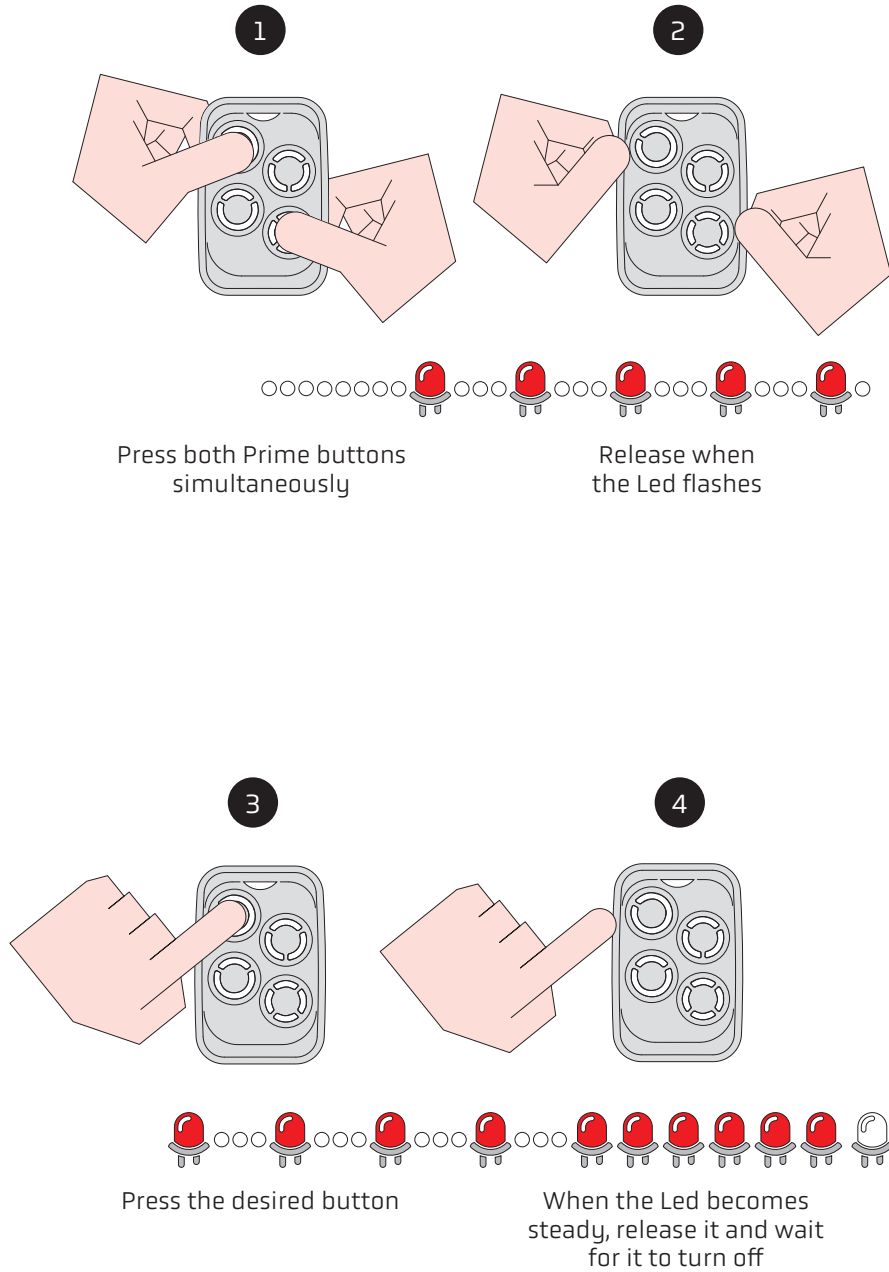



## MANUAL RECEIVER STORAGE

The programming must always be performed with the gate closed, by manually pressing the button on the radio board of the system. On the receiver, press the button (which may have different names depending on the brand) MEMO, PRG, PGM, RADIO, CODE, or P, and then press the button of the programmed remote control.

**Attention!** It is recommended to consult the system's user manual as it may vary by brand and model.

### GENERIC EXAMPLE

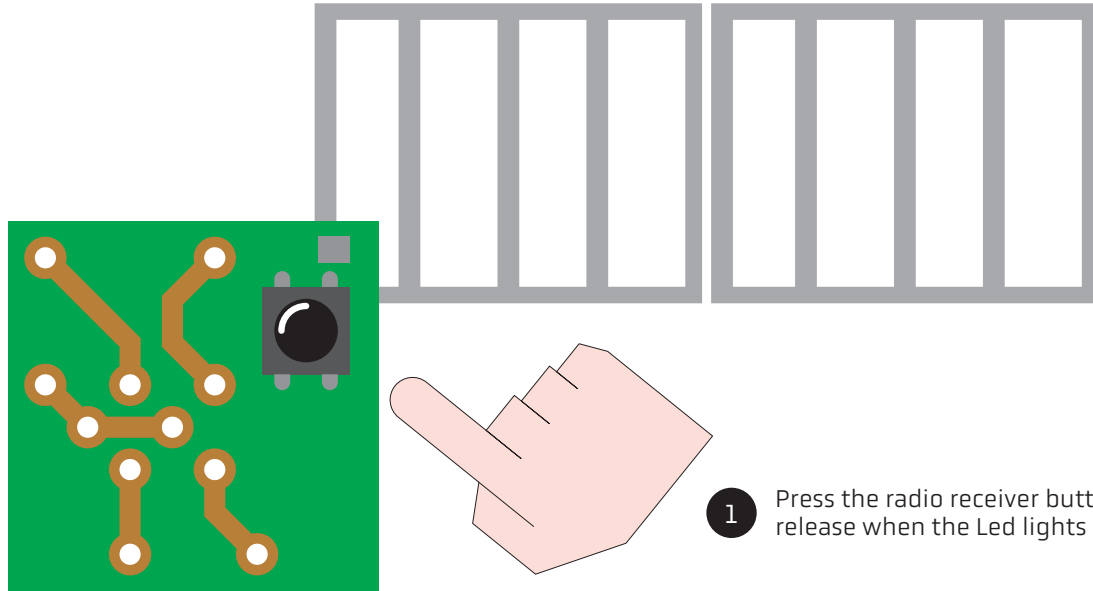

- 1 Press the radio receiver button and release when the Led lights up

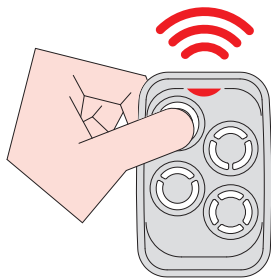

- 2 Press the programmed button and release it when the Led on the receiver flashes or goes off to confirm

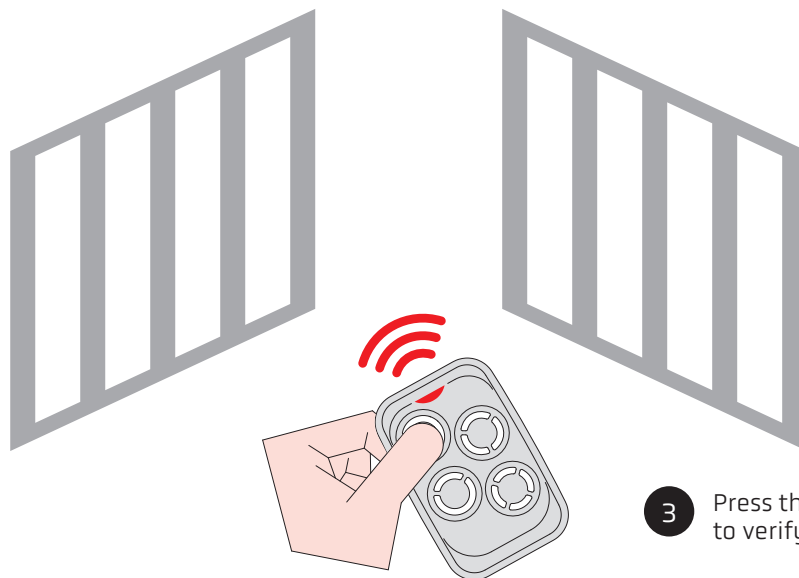

- 3 Press the programmed key to verify correct operation



## AUTOMATIC RADIO RECEIVER STORAGE

Storage must always be performed with the gate closed.

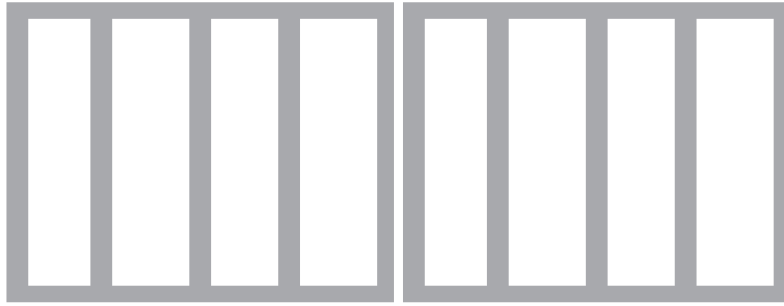

1 Press the programmed button

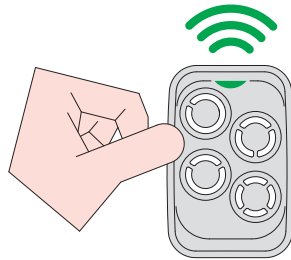

2 Release when the green Led flashes



3 Once the green flashing is over, press the same button again to confirm operation.

**Attention!** It is possible that at the end of the whole procedure it may be necessary to press the button on the original remote control several times until it works again.



## DIRECT LEARNING

Once the key has been programmed, the radio control will be functional immediately.



- 1 Press the button one or more times until the gate opens





## HIDDEN BUTTON/SOURCE FUNCTION

1

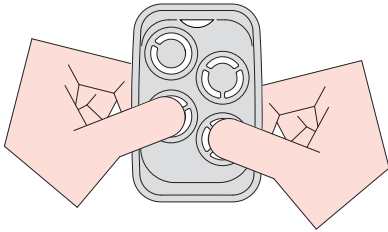

Press both buttons  
simultaneously

2

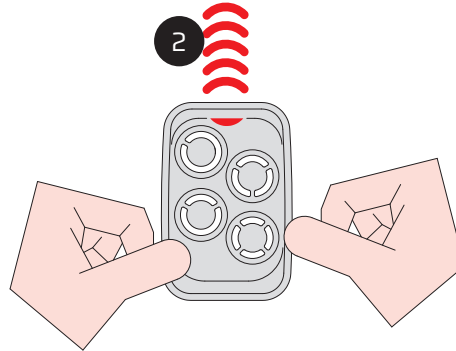

Release when  
the Led flashes

3



Press the programmed  
button: as long as it is  
held down, it will transmit  
the source code